



January/February 2006

FOOT PRINTS



www.sandypines.com

IN THE SAND



*New
Playground
Equipment*

*In
The
Park!*



2745 - 136TH AVENUE
HOPKINS, MI 49328

PRSR STD
US POSTAGE
PAID
WAYLAND, MI
49348
PERMIT #1



NEWS

PHONE NUMBERS

Member Service.....	616.896.8315
Monday-Friday 8:30 am - 4:30 pm	
Saturday & Sunday Closed	
Fax Number	616.896.7409
Member Service (Mary)	100
Member Service	101
memberservice@sandypines.com	
Admin (Ethel/Max)	105
director@sandypines.com	
ethel@sandypines.com	
Admin (Dawn)	109
dawn@sandypines.com	
Admin (Beth)	106
beth@sandypines.com	
Code Inspector (Ron).....	107
inspector@sandypines.com	
Call for Pumpouts	111
Sales Office	616.896.8315
Monday-Friday 8:30 am - 4:30 pm	
Tours by Appointment Only	
Sales (Kelli)	103
Sales (Skip)	115
Sales (Denny Johnson)	114
Sales (Mary Grill)	113
Camping	103
sales@sandypines.com	
camp@sandypines.com	
Maintenance	616.896.8317
Monday-Friday 8:00 am - 4:30 pm	
Saturday & Sunday Closed	
Ranger Station	616.896.9006
ranger@sandypines.com	
Laundromat Hours	6:00a.m.-10:00p.m.
Lake Monterey G.C	616.896.8118
Recreation Department.....	616.896.8318
Park & Garden	616.896.9334
Mini Golf	616.896.7291
Hilltop Dairy Dip	616.896.8868
Country Store	616.896.1569
Golden Onion	616-366-6952
Pat's Little Wheel	616-896-8004
Hair Care at the Pines	616-896-1744

Retail is Closed

Web Site: www.sandypines.com
 Member Only site: User ID: member
 Password: happycamper
Please keep this information handy.

LETTER FROM THE PRESIDENT

By Dean Neild

I hope everyone had a happy and healthy holiday season and enjoyed the times with family and friends.

As we start the new year, I would like to invite everyone to consider a new interest in the park happenings and help the Board of Directors lead the park into the future. We need new and interested people to volunteer for the various committees and groups in Sandy Pines. The Board is responsible for establishing and staffing the various committees and, as President, I am looking for people who have a desire to help. As I meet and talk to people I am amazed at the varied and expertise of our members.

I would like to restaff each committee to try to rejuvenate the life of the park.

Therefore, I am asking that each of you consider the following committees and groups and let me know by the 1st of April of your interest to serve on one of the committees or groups. I will then discuss with the committee chairman and appoint people to committees where possible and forward your name to the groups that need volunteers. This would include people already on a committee, not the groups such as Garden Club or Thurs. Morning Group, to let me know if they would like to stay on the committee so I know of your real interest. With this step I would like to instill a new life blood into Sandy Pines.

Committees:

Finance Committee - Review all checks written by Sandy Pines and Lake Monterey Golf, monthly financial statements, budget for the upcoming year, and all proposed fee and dues increases.

Sales and Hospitality - This committee is going dormant since many of its duties are covered by the Special Events Committee.

Rules Committee - Review the existing rules that govern the membership and recommend any possible changes.

Member Outreach - Supervise and sell Sandy Pines logo clothing, set up programs to improve communications in the park, maintain bulletin boards at the CC's and other locations, and work with the Garden Club.

Special Events and Activities - Coordinate and operate the park special events.

Vision 2010 Committee - Study and recommend to the Board future projects for the betterment of Sandy Pines.

Maintenance Committee - Discover and analyze any maintenance needs throughout the park and report them to the board.

continued on Page 4



Board of Directors

Dean Neild	President
Marti Parks	Vice-President
Rudy Fojtik.....	Secretary
Don Ruthruff.....	Treasurer
Marty Brady	Rich Huizinga
Jack Green	Ed McDonald
Sue VanZandbergen	

Administrative Staff

Max E. Gibbs.....	Park Director
Lon Arndt	Maintenance Supt.
George (Skip) Fuller	Resort Activities Manager
Dawn Arndt, CPA	Finance Admin.
Steve Deyarmond.....	Safety Director
Jim Spray	Golf Course

Management Staff

Mary Cooper	Member Service
Kelli Blackman	Guest Service Manager
John Parmeter	Park & Garden Manager
Ron Lancaster	Code Inspector
Becki Arndt	Supervisor of Swimming Programs & Pools
Wendy Gunn	Supervisor of Youth/Teen Recreation Activities
Ethel Visser.....	Executive Assistant

PARK DIRECTOR

by
**Max
Gibbs**



The year 2006 is here already. It seems only yesterday that we were worrying about the change over to the year 2000. The old saying that the older you get the faster time goes, does seem to be true.

The winter months are also moving very quickly and it won't be long before you will be back to Sandy Pines.

The lake which was getting lower

every day this fall has finally stabilized and is moving in the other direction. The Rabbit River pump was activated on the 1st of January and is now putting more than an inch of water a day into the lake. The snow fall has been above normal and this also helps. The lake will be back to full by the time you need it for summer activities. We were able to do a lot of work on the beaches this fall because the lake was so low. This will make it easier for the boaters this summer.

We are working on plans for the Recreation Department and we will have new programs for adults and

kids. The swim program will be increased and will have a number of new activities.

We are working on the member only section of our web site and this will have new features for our members.

Our goal is to make our services and programs more convenient for you. All of our staff work everyday to make Sandy Pines the best it can be and changes do take place with this idea in mind.

Have a safe and healthy winter. Spring will be here soon.



OFFICE HOURS

Monday-Friday

8:30 a.m. - 4:30 p.m

Saturday & Sunday - Closed

Convenience Centers Open this Winter:

Core-Pavilion	Phase 1
CC#2	Phase 2
CC#3	Phase 2
CC#6	Phase 3
CC#8	Phase 4
CC#12	Phase 5
CC#4 Phase 2, open weekends only	

Cable TV: The price for expanded basic cable in 2006 will be \$166.00. You will receive a bill in April and July for half of the

total (\$83.00). If you are a cable subscriber and no longer want cable for 2006, you need to let us know by March 1st. Once your account is billed at the end of March, you will not be able to cancel cable until the next billing cycle in June.

Automatic Renewal Notice: You should be receiving your renewal notices soon. Please take the time to look the form over and make sure all the information is correct. Be sure to check the expiration on your boat and make sure the stake number is right. The back of the form provides an explanation of how the renewal works and gives you the option to make changes. Send the form back only if you make changes. We will make the corrections and send you a new form to keep for your records. The price on the invoice will be billed to your account in the spring. *Once your account is billed in March, you will not be able to make changes to the renewal form.

Flea Market Dates for 2006: May 6, May 27, June 10, July 1, August 12, September 2, and October 7. Reserve a spot for \$22.00 or all 7 flea markets for \$126.00 (\$18.00 each).

New Members:

- David & Donna Garrett
Byron Center, MI
- Phyllis Brunsting
Palos Heights, IL
- Nancy Jeltema & Robert Patterson
Byron Center, MI
- Lee & Karen Inman
Kalamazoo, MI
- David & Diane Hansen
Zeeland, MI
- Quentin Howard
Kalamazoo, MI
- Kriag Keegstra
Byron Center, MI
- Guy & Delores Lewis
Rockford, MI
- Gladwin & Dolly Kloosterman
Zeeland, MI
- Robert & Lois Johnson
Jenison, MI
- Jeffrey & Juliane Gonyea
Canton, MI
- Thomas & Diane Stout
Zeeland, MI

MORE NEWS

SAFETY DEPARTMENT

By Steve Deyarmond

Snow load:

This winter has had some storms with snow accumulation. Porch enclosure roofs in the past have become damaged from snow load. Please remember to check or have a friend check the amount of snow on your porch enclosure roofs. Remember that Sandy Pines commonly has lake effect snow. As a result the park normally has more snow than inland areas. The ranger station does have phone numbers of persons that clean the snow off roofs. Please contact the ranger station for the individuals that perform this work.

This year the ranger staff has noticed golf cart roofs bowing from the accumulation of snow. In the past this did not seem to be a problem. Evidently golf cart manufactures are making these less weight bearing then in the past. Please check your golf cart roofs for snow accumulation and bowing also.

Lake Ice:

The lake currently has ice but as with all lake areas near inlets, or over springs, or with water current under the ice can have places unsafe. No ice is 100% safe.

A general guideline of four inches of new clear ice is the minimum thickness for travel on foot. A general guideline of five inches of ice is required for snowmobiles. Remember these are general guidelines and many factors besides thickness determine the safety of ice.

Safety tips:

Please supervise youth out on the ice.
Don't venture out on the ice alone.

Take a companion with you.
Carry a couple of ice picks or screw drivers with you to assist you in getting out of the water if you should fall in.

Refrain from driving on ice.

Treadles installed at the Main Gate exit:

The park has installed treadles (tire spikes) on the exit gate at the main gate. Please do not enter or back up over these. Tires subject to these are damaged to the extent that they can not be repaired.

Snowmobiles usage of the park:

Please operate snowmobiles on park roadways and abide by the m.p.h. speed limit. Please do not cut across member sites and if operating on the lake be careful not to run into a boat stake along the shore of the lake. Snowmobiles trails are nearby Sandy Pines and retailers near the park have local trail maps that can be purchased.

CODE INSPECTOR

By Ron Lancaster

The poet tells us that "only God can make a tree." Well, we all know that there is truth to that and that is why we are so protective of our trees here at Sandy Pines. Please consult your handbook before you plan to remove any tree here in the park.

As your new code inspector, I would also like to take this time to remind you that any contractor must be licensed with the park to do any work on your site. Please feel free to contact me to see if they are cleared first.

My office is located in the Ranger Station now and I will not be at the

Administration building at all. My phone number remains as before (616) 896-8315 ext 107. If you wish to e-mail, please do that at inspector@sandypines.com.

I cannot tell you how I appreciate serving you in this new position. I want to thank you for being patient with me as I try to figure out what I am trying to do here.

May you all have had a Blessed Holiday and a Blessed new year.

See you in the Spring....

continued from Page 2
President Letter

Golf Course Committee - Analyze and review the operation of the course and try to improve the overall golf experience.

Volunteer Groups:

Garden Club - Maintain and improve the garden areas around the park including CC's and green areas.

Thursday Morning Volunteers Work on projects to maintain the campsites and grounds at Sandy Pines.

The Board of Directors are working and will continue to work for the good of Sandy Pines and need the help of many positive and interested people.



MORE NEWS

PHASE MEETINGS 2005

This past summer we had Phase Meetings to meet with and ask the Park Director questions or voice concerns about Sandy Pines.

I would like to report on what we have done with your suggestions:

1) Installed a fence in the middle of the island in Phase Two road way.

2) Painted a dividing line at the boat ramp to divide it into two sections.

3) The Board of Directors will be considering a new rule on the number of tubers and skiers that a boat can pull behind.

4) We are working on a plan to offer boat safety classes this spring.

5) We are adding "Ask the Park Director" area to our web site under the Member Only Section.

6) We have added a security phone outside the Phase Three guard station that gives members access to the Main guard station.

7) We are working on a plan to add a Ranger to the Phase Three guard station during the week in the summer.

8) We rearranged the dumpsters in Phase Three so that there was a short dumpster in each area to help our shorter members.

9) We widen the intersection in Phase Two and the golf cart entrance by cutting down trees and brush. This increased the vision area for our members.

10) The Board of Directors will be voting on additional over flow parking area in Phase Three.

11) We have added handicapped parking spaces at each CC.

12) We checked into having an Epi Pen to be used by the Rangers to help people who have allergy reactions. We were told this could only be issued by a prescription by the Doctor and we cannot have one.

SANDY PINES FLORIDA GATHERING IN 2006

The date is Tuesday, February 7, 2006. The location is at Barnhills Buffet (same place as last year) in Lakeland, Florida. The costs have gone up and our price

for 2006 will be \$9.00 per person or \$18.00 per couple. The process will be the same—send your check and we will send a confirmation card back to you giving directions to the restaurant. Please bring this card with you so that we can get through the entrance as conveniently as possible. Of course, we will have door prizes.

Lloyd & Winnie Flessner
1616 Foxway Drive
Lakeland, FL 33810
Wlpiners@aol.com

If you e-mail us, put on the subject line: Sandy Pines Gathering

UNITED BANK

**For your added convenience,
visit the Burnips Marathon
ATM & Banking Center
142nd & 30th • Burnips, MI**

- ✳️ Get quick cash
- ✳️ Transfer funds
- ✳️ Check your account balance

**616.681.9927
or 800.968.1900**





MORE NEWS



SUNTARRA™ SUNROOMS

professionally Installed by:

FRED'S PRO HARDWARE

- Each Suntarra™ Sunroom is custom Designed and Engineered for your application.
- Meets or Exceeds your local Building Codes.
- Heavy-Duty Aero-Core™ structural reinforcement provides a lifetime of reliability.
- Fully-Insulated for Year-Round enjoyment.
- All-Glass Knee-Walls, Doors, Windows and Transom available.
- Energy-Star rated to save utility \$\$\$.
- Increase Living Space at a fraction of regular remodeling costs.
- Highly Durable, Long Lasting Vinyl, components absorb sound for a quiet living space.
- Integrated Electrical Raceway.



FRED'S PRO HARDWARE
3333 STICKNEY AVE.
TOLEDO, OHIO 43608

Sandy Pines Member

(419) 729-1961

Go to the Head of the Parade with **Club Car**®



See the new
Precedent
models today!

- New
 - Used
- Service, Parts, Batteries
4, 6 and 8 passenger cars

800-321-9616

9670 Cherry Valley Ave., S.E.
Caledonia, MI 49316



Monterey Pines Golf Carts

Enjoy the Good Times



- Sales
- Service
- Rentals
- Parts
- Accessories

*New • Used
Reconditioned*

**4 and 6 SEATER
RENTALS - Low Rates**

**Boats In & Out
Service**

269-793-2277

*Serving Sandy Pines
Next to General Store*

2730 136th Ave. • Hopkins, MI
Let the GOOD TIMES ROLL!

PRECISE CARPET CLEANING



Get it done the "Precise Way"

- Sand Extracting Vacuum
- Pre-Spotting
- Detergent Application
- Carpet Scrub
- Truck Mount Extrication with Sanitizer

**SANDY PINES SPECIAL
3 Rooms & Hall for
\$99**

Take an additional \$10 off if we
clean your neighbors the same day.

Call: 616-293-2374

Monterey Pines General Store

Enjoy the Good Times

- Beer • Wine • Liquor
- Sandwiches • Snacks
- Movies • Groceries • ATM
- Lotto • Hunting & Fishing Licenses
- Firewood • Camping Supplies

269-793-9721

Gift
Certificates
Available

Daily 8 a.m.-10 p.m.;
Fri. & Sat. 8 a.m.-11 p.m.

Serving Sandy Pines
Across from Sales Office
2730 136th Ave. • Hopkins, MI
Your ONE STOP GOOD TIMES Shop!



MORE NEWS

FOR SALE: N392 Phase 4, "Recreation Ready" with furnished 2003 Castle Point with "extra High" double loft plus full length 3-season porch, golf cart w/DbI shelter, and utility shed. Including lot, \$59,000.00 complete. Phone 616-893-6695

FOR SALE: 4 seater Club Car, windshield wipers, lights, horn mirror, seat belts, turning signals, overhead cover \$4,500 OBO Phone 1-616-886-0831

FOR SALE: N396 (Site Only) Larger than the average lot, \$18,900. Phone 313-388-9465

FOR SALE: 1985 Crest outboard, 21ft, \$2600.00 OBO N161 586-214-0714

FOR SALE: 2004 Hitchhicker II 5th wheel trailer, 36ft, with 3 slideouts, loaded plus aftermarket extras \$45,000. Phone 269-963-2504 and 2002 Chevy 3/4 ton heavy duty truck, diesel, 4X4, towing package truck, loaded plus hitch, brake controller, tool chest & cover, \$30,000 or both for \$72,000 OBO.

FOR SALE: Empty Lot 739, on Southwoods Trail, Phone 616-886-0574.

FOR SALE: Lot 688, 2003 Park Model with full length 3-season porch, golf cart included \$52,000.00 call 616-866-5159 for more information.

WANTED: Lot Only Call 896-1573, 734-459-3481, or 850-650-4388.

FOR SALE: New! Never set-up: Premium All-Season Suntarra Sunroom. 10'x32', white, 3" insulated with vinyl windows and screens; 2 six foot sliders. Retail Value: \$19,500 uninstalled. Will sacrifice \$14,500 installed. 616-291-2074.

FOR SALE: D134 1996 Cedar Ridge golf cart, boat stake, fully furnished, paddle boat, shed, \$112,900. Call 616-293-0065 or 616-878-4123.

FOR SALE: Lot 232, Phase I, 40 ft. trailer (5th wheel) with 2 tipouts, 10x20 3-season porch (new roof and carpet), new shed, golf cart (new batteries), grill, picnic table, dues paid, winterized, 5 minute walk from main beach, \$31,900. Call Jerry at 616-460-2197.

FOR SALE: N250, Phase 4, \$44,500, 1993 Avalon, 1 bedroom, enclosed porch, 2 electric carts with garage, 2 decks, shed, furniture. 2006 dues paid, call 616-395-1542

FOR SALE: D165, Beautiful lakefront lot, 2002 Trophy Park Model with king size bed and large kitchen, Westhouse porch with heat pump, also includes shed, 2 golf carts with

garage, pontoon boat with dock, 2 large decks, underground sprinkling, \$134,900. Call 616-457-0414 or cell phone 616-885-7959.

FOR SALE: Site 362, Prime lakefront with 1991 Chalet trailer, pontoon, enclosed porch, fire pit, a/c, golf cart, and shed, furnished, large parking, \$97,900. Call 616-460-0012.

FOR SALE: Site N401 (Site Only), large lot, nice neighbors, 2006 dues paid, \$19,900. Phone 517-423-0007, leave message.

FOR SALE: 10x27'4" Porch, brown with windows, taken down and in storage. \$1,500. Call 269-673-1502.

WANTED: Rebuildable Golf Carts and Parts, does not have to be running. Call Russ at 734-699-5843.

FOUND: at Sandy Pines, a ladies ring. Call Tom Latterner at 269-375-0493.

**PLEASE NOTICE - To clarify the placement of an ad for the classifieds.
The ad is run until you call the office to cancel it.**

MEMBERSHIP DIRECTORY

By Sue VanZandbergen, Chairperson Members Outreach Committee

There has been a lot of discussion about having a membership directory of the members of Sandy Pines. Discussions have been held the last couple of years to find a way to do this without compromising the privacy of our members.

This winter, we are going to print a directory of members who would like to be in a directory. You will need to fill out the attached form and send it to the office if you want to be in the directory. You will have a couple of choices. You can have name and site number, or your name, site number, and mailing address. Please fill out the form accordingly and return it to the office.

There will be a charge to cover the cost of the directory. This will be determined based on the size.

Membership Directory

I would like to be included in the directory:

Name _____

Site Number _____

Optional - Mail Address _____

Signed _____

You must sign this form to be in the directory - Return to Member Service Office

MORE NEWS

SANDY PINES MEMBERS

There are members in the winter that meet at the Old Country Buffet the 3rd Thursday of the month at 6:00 pm. In February they will meet at the Kalamazoo restaurant and in March they will meet at the Grand Rapids restaurant.

ATTENTION

All Sandy Piners in Arizona Mark your calendar for February 8, 2006 which is the reunion date.

Where: Old Country Buffet
6625 E. Southern
Mesa, AZ
In front of Superstition
Mall

Time: 11:30PM
Come and bring another
Sandy Piner with you.

PLEASE NOTE CHANGE OF TIME AND PLACE

For more information call Etta Whelan at 480-201-6101.



Russo's

PIZZERIA

**4285 30th St.
Burnips, MI**

616-896-4900
Fax/Voice: 616-896-4901

Hours: Mon-Thurs 4-10 pm;
Fri-Sat 4-11 pm; Sun 4-9 pm

**PIZZA
DELIVERY
TO SANDY
PINES**



We accept Visa, MasterCard & Debit Card.
Sorry No Personal Checks

*Catering Available from
Russo's Pizzeria*

T & L SERVICES LLC

LANDSCAPE DESIGN & BUILD

Outdoor Living Spaces, Brick Patios, Walks, Steps, Retention Walls, Paved & Stone Driveways, Water Falls, Ponds & Lighting

LAWN & SITE CARE

Fall & Spring Leaf Removal
Lawn Maintenance, Snow Removal, Gutter Cleaning, Roof Sealing, Site Development, Sod Installation

FULL CLEANING SERVICE

Deep Cleaning Interior's
Deluxe Window Washing
Professional Carpet Cleaning

DECK CONSTRUCTION

Deck Building & Restoration
Pressure Washing, Repairs,
Sealing & Staining

PRESSURE WASHING

Park Models, Trailers, Porches
Homes & Patios, Waxing

CUSTOM WORK

Skirting, Porch & Interior Painting
Fence & Lighting Installation
Home Improvements

Free Estimates
269-673-1502
616-218-5450
616-896-6997



Terry Emelander, Owner
Licensed & Insured
Sandy Pines
Member & Contractor

*"Dependable Quality Service You
Can Count On For Over 27 Years"*

COME SEE US AT THE FLEA
MARKETS PORTFOLIO &
REFERENCES AVAILABLE

Sympathy

We would like to extend our sympathy to:

Diane & Frank Hall, Site 920, **Carroll & Linda Aardema**, Site 649, in the passing of father and brother-in-law John Smith on October 31, 2005.

Ed & Lois Matthews, Site K294, in the passing of Ed's father, Rev. John H. Matthew on November 2, 2005.

Diane Welsh, Site 1305, **Donald & Beatrice Welsh**, Site N349, **Harold & Eunice Shock**, Site 1226, **Juanita St. Bernard**, Site 1304 in the passing of husband, father, and brother, Dick Welsh on November 7, 2005.

Joni & Doug Hyde, Site N40, **Judy & Jim Bolthouse**, Site K6 in the passing of their father, Mitch Jannereth on November 24, 2005.

Joy Witte, Site K298, **Paul & Linda Witte**, Site K112, in the passing of husband and father, Paul Witte on November 27, 2005.

Gerald Phillips, Site 977, in the passing of his wife Carol Oliver-Phillips on December 8, 2005.

Charles & Debra Peterlein, Site 134, in the passing of her father, Abraham "Jack" Tornga on December 8, 2005.

Denise Kincaid, Site 872, and **Holly and Dave Thomas**, Site 869, in the passing of husband and brother, Ty Kincaid on December 22, 2005.

Sue VanZandbergen, Site K304, in the passing of her husband, Bob VanZandbergen on December 27, 2005.



MORE NEWS

SALES OFFICE WINTER HOURS

From November 1, 2005 to April 1, 2006, Denny Johnson will be available by appointment only for tours and showings of our current listings. Denny can be reached at 616-366-5018.

LAKE MONTEREY

Our lake is one of our most valuable assets and when the water level begins to decrease, our members become concerned.

The summer of 2005 was very similar to the summer of 1999. The lake level matched our lowest level. The lake was five (5) ft low this fall. We know that it is not what we want, but even with pumps working 24 hours a day, 7 days a week, we cannot keep up with the evaporation that occurs on those hot summer days.

The low lake level does have some advantages. We were able to work on the beach areas and moved the dirt from the original lake bottom back up onto the beach. We have worked in Phase One, Two, Four, Five, and Six this fall. We have over 1,400 boats registered at Sandy Pines and this work will make it easier to use your boat.

We have our pumps working and we will use our pump to take water from the Rabbit River during the months of January, February, and March.

Mother Nature also helps during the winter months and spring. We should have the lake level back to where it belongs by spring.

We also planted 1,000 Walleye this fall, so bring your fishing pole and enjoy yourself this summer.

CONGRATULATION

We would like to congratulate our Park Director, Max Gibbs. He was elected the Chairman of the Board of Directors of the National Association of R.V. Parks and Campgrounds.

This association has over 3,900 campgrounds and R.V. Parks in its membership. The Board of Directors is made up of 28 Board members elected by the total membership. Max was elected to the Board by the six state region that Michigan is assigned. He was elected two years to the Board and now has been elected to the highest position on the Board.

Max will be representing Sandy Pines all across the United States and will be involved in activities and events that will make the Sandy Pines' name known all over the country.

LAKE MONTEREY GOLF COURSE

The Board of Directors and the golf course committee have introduced some new plans

and pricing for the 2006 golf season.

The golf course is a very important asset to Sandy Pines and we want it to reflect what our members want, as well as an independently financed operation.

The cost of operating the course increase every year just like Sandy Pines. Our management team works hard to keep the costs of operation as economically as they can, but cost do increase.

The new rates for 2006 are the same as 2005 and the dual playcard has been removed and the price of the new playcard was determined by averaging last years double playcards.

We have studied the rates at other courses and our rates in each membership, playcards, daily and weekend rates are still the best in the area.

The course will continue to improve as it has over the last four (4) years that we have owned it. We appreciate all of our members who enjoy our course. We hope that by keeping the rates the same as last year, that you will see we are serious about your concerns.

Have a great golf season and send in your form today, so you can take advantage of the discounts.

MORE NEWS

Who's protecting your park model when you're not there?

Getting away is great... but not if you spend your time between visits worrying about your park model.

When you buy your insurance from Northern Lights Insurance Agency you get the kind of coverage that lets you relax all week... not just on weekends.

Call Northern Lights today. While we're talking ask us about a no-obligation quote on your Motor Home, Travel Trailer, ORV, Motorcycle, Snowmobile, or Watercraft and Boat Insurance as well.

Toll Free
1-800-577-1780
E-Mail

NorthernLightsGrandRapids@Foremost.com

On the web at

www.northernlightsinsurance.com



Representing



956143 02/98

New ATM!

Discover the new and improved cash dispensing ATM - available 24 hours a day, 7 days a week for your convenience!

Main entrance, next to the Ranger Station.



Banking ♦ Insurance ♦ Investments

1-800-747-5004

www.bankatbyron.com

Member
FDIC

Now Open! Units Available!

Salem Self-storage

Features:

- Security Fence and Gate
- 24/7 Keypad Access
- Lighted Asphalt Drives
- Outdoor Storage
- Clean and Dry
- 6- or 12-Mo Pre-pay Discount

Unit size	Door size	Monthly
5' x 10'	3' 8" x 7' - 8'	\$25
10' x 10'	8' 8" x 7'	\$45
10' x 15'	8' 8" x 7'	\$60
10' x 20'	8' 8" x 7'	\$70
10' x 30'	8' 8" x 7'	\$105
12' x 10'	10' 8" x 8'	\$55
12' x 30'	10' 8" x 8'	\$120
12' x 40'	10' 8" x 8'	\$150
Outdoor		\$30 or \$275/year prepaid

Additional Units Available Upon Request!

2783 136th Ave. (West of Sandy Pines office)
262-6244 or (616) 878-9973

UNWIND!

IN YOUR CUSTOM BUILT SUNROOM

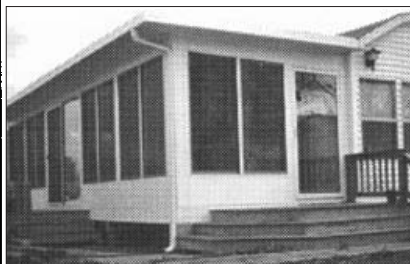

from JAMESTOWN PATIO

Areas Widest Selection
of 3 and 4 Season
Sunrooms

Call Today for a FREE Estimate

896-6780

800-828-5937

www.patirooms.com

ELLIS SALES, INC.

'Since 1937'

West Michigan's only
Factory Authorized E-Z-GO Fleet Dealer



Golf Cars & Utility Vehicles
New, Reconditioned & Custom



Sales, On-Site Service, Delivery, Parts,
Batteries (new & used), Rear Seats,
Lift Kits, Light Packages, Windshields
and other Accessories

6915 STADIUM DRIVE
KALAMAZOO, MI 49009

800.962.4128

www.ellissalesinc.com

SANDY PINES FAVORITE SUPERMARKET

Conveniently located on 142nd Ave.,
just East of Dorr

- BEST PRODUCE
- DELI
- BAKERY - FRESH DAILY!
- FRESH MEATS (*Great on the Grill*)
Including our Renowned
HOMEMADE VARIETIES OF
FRESH BRATS AND
SMOKEHOUSE WIENERS

DICK'S MARKET

Our Family Serving Your
Family Since 1955

1614 - 142nd Ave.
DORR, MI 49323

616-681-9521

Mon.-Sat. 7 am-9 pm;

Sun. 10 am-7 pm





The Condominiums at Sandy Pines

Now Open!

THE CONDOMINIUMS OF SANDY PINES

By Appointment Only

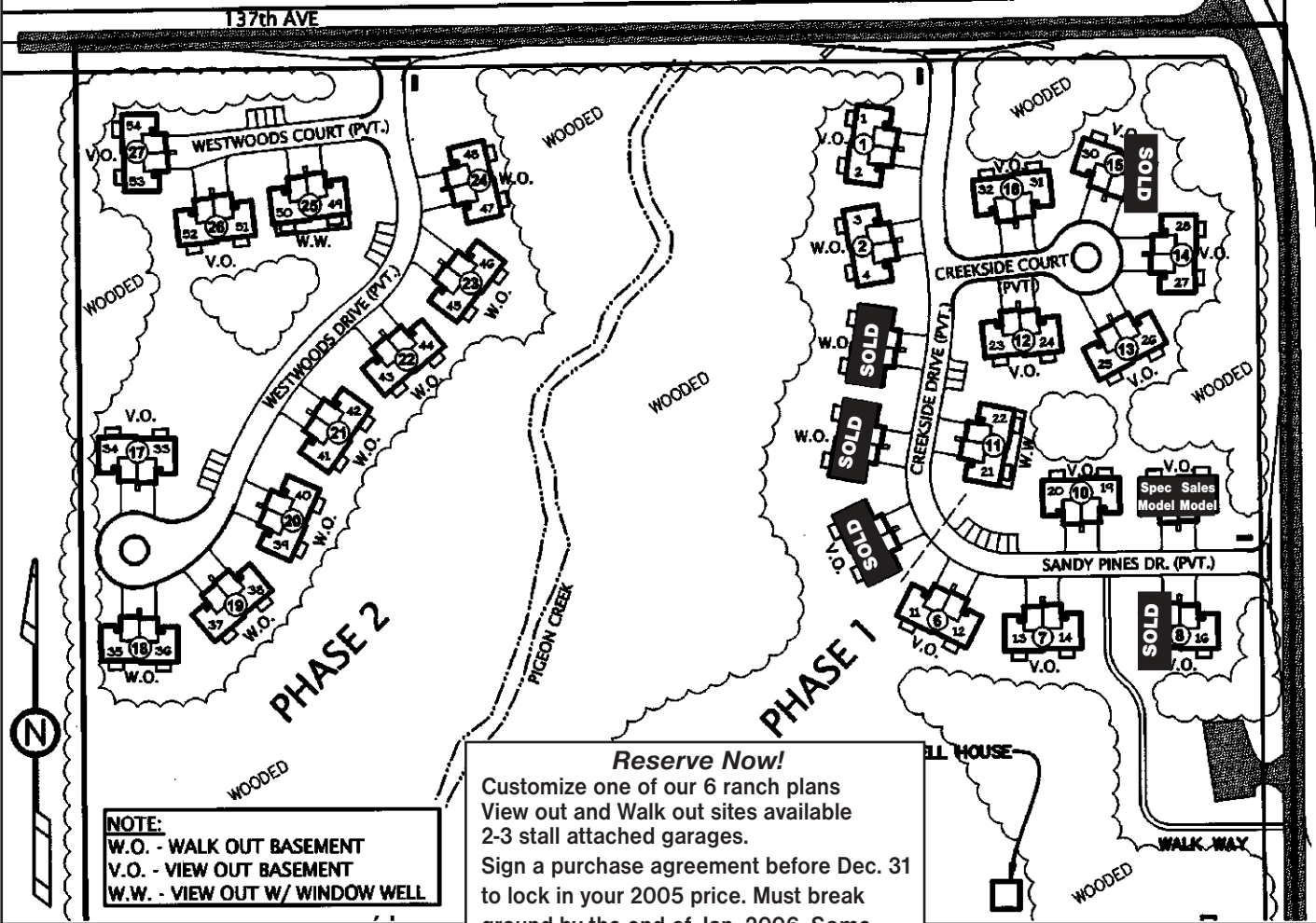

NOTE:
 W.O. - WALK OUT BASEMENT
 V.O. - VIEW OUT BASEMENT
 W.W. - VIEW OUT W/ WINDOW WELL

Reserve Now!
 Customize one of our 6 ranch plans
 View out and Walk out sites available
 2-3 stall attached garages.
 Sign a purchase agreement before Dec. 31
 to lock in your 2005 price. Must break
 ground by the end of Jan. 2006. *Some
 restrictions apply.*

Duplexes from \$137,700
Prices subject to change without notice

Call Linda Hall
616-292-4848





DORR STANDARD SERVICE
 1831 142ND AVE.
 DORR, MICH.
 24 HR WRECKER SERVICE
 C STORE
 DAYS 681-9136
 NIGHTS 681-9935 - 681-9723
 CERTIFIED MECHANICS
 COMPLETE FULL SERVICE STATION

INSURANCE
 Coverage for:
 • Park Models • Boats
 • Auto • Home

Discounts for Age 50 & over!

Beukema Insurance Agency
 6536 S. Division, Grand Rapids, MI 49548
 (616) 281-6990 or
 1-800-350-6899

Winterizing of Park Models/Trailers & Boats
 B & L Enterprises - Sandy Pines Members
 Lawn Care, Block Walls, Decks,
 Landscaping, Patios, Roofs
 Butch: 616-293-0065 or 616-896-8053

Hopkins Cylinder Service
 Free Delivery  Best Service
 Unbeatable Prices!!!
 269-793-3400 • 1-800-914-5213



MORE NEWS

LAKE MONTEREY GOLF COURSE

2006 Seasonal Prices

Weekday and Weekend

Playcards ***

Regular Price March 18, 2006

	Weekday Playcards	Special for Sandy Pines Member only
_____ 10 Plays	\$ 92.00	\$ 87.50
_____ 20 Plays	\$ 182.00	\$ 170.00
_____ 30 Plays	\$ 262.50	\$ 253.50
_____ 40 Plays	\$ 345.00	\$ 334.00
_____ 50 Plays	\$ 440.00	\$ 420.25
_____ 60 Plays	\$ 500.00	\$ 482.00
_____ 70 Plays	\$ 562.00	\$ 542.50
_____ 80 Plays	\$ 625.00	\$ 600.00
_____ 90 Plays	\$ 674.00	\$ 652.50
_____ 100 Plays	\$ 710.00	\$ 700.00

Limited Memberships****

_____ Students (Under 18)	\$140.00	\$120.00
_____ Single	\$438.00	\$400.00
_____ Couple**	\$570.00	\$500.00
_____ Family**	\$590.00	\$545.00
_____ Senior Single*	\$410.00	\$390.00
_____ Senior Couple*	\$500.00	\$480.00

7 Day Front Nine Playcard

	Regular Price	March 18, 2006
_____ 10 Plays	\$ 70.00	\$ 65.00
_____ 20 Plays	\$ 150.00	\$ 135.00
_____ 30 Plays	\$ 217.00	\$ 195.75
_____ 40 Plays	\$ 280.00	\$ 252.00
_____ 50 Plays	\$ 337.50	\$ 304.50
_____ 60 Plays	\$ 390.00	\$ 350.00
_____ 70 Plays	\$ 437.50	\$ 400.00
_____ 80 Plays	\$ 480.00	\$ 430.00
_____ 90 Plays	\$ 517.50	\$ 465.00
_____ 100 Plays	\$ 550.00	\$ 500.00

Not Valid on
Holidays or
League Play

Unlimited Play

_____ Single	\$810.00
_____ Couple	\$925.00

Unlimited Play - Memorial Day to Labor Day

_____ Single	\$700.00
_____ Couple	\$800.00

Trail Fees

	One Cart	Second Cart
_____ Yearly	\$130.00	\$50.00
_____ 10 Trail Fees	\$15.00	
_____ 20 Trail Fees	\$30.00	

****Limited Memberships: (Special) Two weekend plays after 3:00 P.M.

All Limited Membership are good for weekday play only. Not good on Holidays or Saturday, July 1, 2006.

*Seniors - Senior Single membership are for players at least 62 years old. Senior Couples must be a married couple at least 62 years old.

**Family Memberships include parents and single children that are hom and under 21 years old. Couples membership are for married couples only.

***Playcards

Playcards are for prepaid 9 hold rounds that can be used at any time by any player you designate. Playcards expire at the end of the season.

2nd Card Policy

Players running out of plays may purchase 20, 30, 40, etc. playcard for the spring rate for that card. Any remaining plays will be carry over until June 8, 2007.

2nd Trail Fees

Members may carry over a 2nd 10 or 20 trail fee card until June 8, 2007.

Make checks payable to: LAKE MONTEREY GOLF COURSE 2745 136th Avenue Hopkins, MI 49328

Name _____ Site Number _____

The Board of Directors and the golf course committee have introduced some new plans and pricing for the 2006 golf season. The golf course is a very important asset to Sandy Pines and we want it to reflect what our members want, as well as an independently financed operation. The costs of operating the course increase every year just like Sandy Pines. Our management team works hard to keep the costs of operation as economically as they can, but costs do increase. The new rates for 2006 have been rolled back to the same rates that were charged in 2004. The Board wants to encourage you to take advantage of these new rates and play more at your golf course. We have listened to our members and even though expenses continue to increase, we have lowered our prices. We have studied the rates at other courses and our rates in each membership, playcards, daily and weekend rates are still the best in the area. The course will continue to improve as it has over the last four years that we have owned it. We appreciate all of our members who enjoy our course. Have a great golf season and send in your form today, so you can take advantage of the discounts.



MORE NEWS

Discover **4 Season Living!**
the advantages of Sandy Pines
new Condominiums for yourself!
No inside units that are dark!

Come in and check out our:
Six different models



Spacious floorplans with cathedral ceilings
 Walk-out basement option

Sunroom with French doors option
 Attached 2-car garages Large bath & laundry rooms
Maytag microwave & dishwasher included.

Kitchens with fine cabinetry & +++ storage

Learn more about these **great features & more!!**

For more information:
 616-292-4848
 Linda Hall
 RDI Companies



Sandy Pines Sales

616-896-8315
 Denny Johnson, Ext 114
 Mary Grill, Ext. 113

MORE NEWS

HELLO EVERYONE FROM DAIRY DIP:

We hope that everyone started out the New Year right (with some Ice Cream). We just wanted to say thank you to everyone who faithfully supports our business, and makes working so hard all summer long a joy!

We are already gearing up for summer, making necessary changes and improvements to give you better service.

We again are looking to fill some openings due to college students moving away. We are always sad to see them go but enjoy having them around for several years. We will be conducting open interviews the fourth weekend of April on Saturday and Sunday (22nd & 23rd) from 1:00-3:00 PM. You may also call 616-366-8723 if you can't make that day or drop an application off at the main office.

What we need is a four-month commitment. All though we know that summer is the time for family trips, it is unfortunately our busiest time of the year. We do try to work with summer camps as best we can, but we don't want kids missing holidays, and extended days. If you can't give that

commitment we understand, but ask that you prayerfully think about what kind of commitment we are asking for and then decide if your child can commit to it.

Thank you, and see you in the spring (think Hudsonville...yum, yum)

Jeff & Toni Bredeweg

BOARD MEETING SATURDAY, JANUARY 7, 2006

Motion by Fojtik, second by McDonald to accept the resignation of Marty Brady from the Board of Directors.

Vote: All Yes Motion Carried

Motion by Parks, second by Ruthruff to accept the new members given to the Board by the Sales Department

Vote: All Yes Motion Carried

Motion by Fojtik, second by Neild to limit the number of tubers or skiers being pulled by a boat to three.

Vote: All Yes Motion Carried

Motion by VanZandbergen, second by Woodward to accept the phone votes as read into the minutes:

Motion by McDonald, second by VanZandbergen to donate \$1,000 to camp-

ground victims of Hurricane Katerina

Vote: All Yes Motion Carried

Motion by Green, second by Ruthruff to cancel the survey

Vote: Huizinga, Ruthruff, Green, Brady, McDonald Yes; VanZandbergen No; Fojtik, Parks, Neild Abstain

Motion Carried

Motion by Ruthruff, second by Green to accept the 401K plan changes

Vote: All Yes Motion Carried

Motion by Parks, second by Brady to schedule 2 rangers in the park to cover Monday thru Friday, Daily 5:00PM to 7:00AM and Weekends Friday 5:00PM to Monday 7:00AM

Roll Call Vote: Brady, Green, McDonald, Neild, Parks Ruthruff, VanZandbergen Yes; Fojtik Abstained; Huizinga No

Motion Carried to insert the phone votes into the minutes

Motion by VanZandbergen, second by Parks to allow overflow parking in Phase 3 from Site 1001 to playground area and from CC#5 to Site 1006

Vote: All Yes Motion Carried

MORE NEWS

SANDY PINES BOARD OF DIRECTORS MEETINGS FOR 2006

Time	Date
April 28	7:30PM
May 19	7:30PM
June 16	7:30PM
July 21	7:30PM
August 18	7:30PM
Annual Meeting	
August 19	9:00AM
September 15	7:30PM

"Auction Action to Your Satisfaction"



RD TILLER
Auctioneers, LLC

Member NAA, MSA, CAGA
Phone (616) 437-9104 E-Mail: roger@rogertiller.com
Fax (208) 379-2296 Home Page: www.rogertiller.com

CORRECTION

Regarding a comment in the last issue about the Maintenance Department - Maintenance does plow the roads in the winter but not on weekends.



Patio Rooms and Decks by Westhouse

- Insulated patio covers warranted to meet Michigan Snow Load Code.
- Standard and insulated sidewalls.
- Sturdy tempered glass windows and patio door rooms.
- Transom Windows and Insulated Glass

Westhouse
HOME IMPROVEMENT

www.westhousehome.com

4409 Chappell St.

Moline, MI 49335-0126

Local (616) 877-4706

or 1-800-359-2018

"Serving the Area for Over 30 Years with Quality and Integrity"

24 HR EMERGENCY SERVICE

R & D SERVICES

Tree Removal • Lot Clearing
Storm Damage/Clean-up
Stump Grinding

Pruning/Trimming • Bucket Truck
& Professional Tree Climbers

Serving West Michigan

FULLY INSURED • FREE ESTIMATES

269-793-7482 • 616-813-3184

866-781-TREE(8733)



Boylan Sales, Inc.



New & Used Golf Cars

Sales • Service
Leasing
Rentals • Parts
Accessories



Call: 1-800-755-CART (2278)

Visit: 607 N. Main St. • Plainwell, MI 49080

Click: www.boylan sales.com • check out our on-line Showroom

On-site Service & Pick Up/Delivery Available

A short 20 min. drive from Sandy Pines, come visit us in Plainwell!

CUT ABOVE Tree Service, Inc.

Affordable - Insured - Experienced
Free Estimates - Professional

- Removals • Trims • Stump Grinding
- Mulch Removal • Lot Clearings
- Woodchips • Complete Clean-up

• Topsoil as Needed

269-857-8023

Toll Free 888-760-3247

"We go out on a limb...for you!"



SCOTT'S CARTS PLUS OPENING SOON!!!



GOLF CART REPAIR
SALES, SERVICE, PARTS
AND ACCESSORIES
AND SPRING SPECIAL'S
CALL 269-929-4084

Vacationland Sales

“Michigan’s largest Park Model Dealer”

PARK MODELS ARE OUR SPECIALTY

*Located directly across
from Sandy Pines*

2746 - 136th Avenue
Hopkins, MI 49328

(616) 896-8371

- Free setup in Sandy Pines
- Excellent financing available
- We Service what we sell

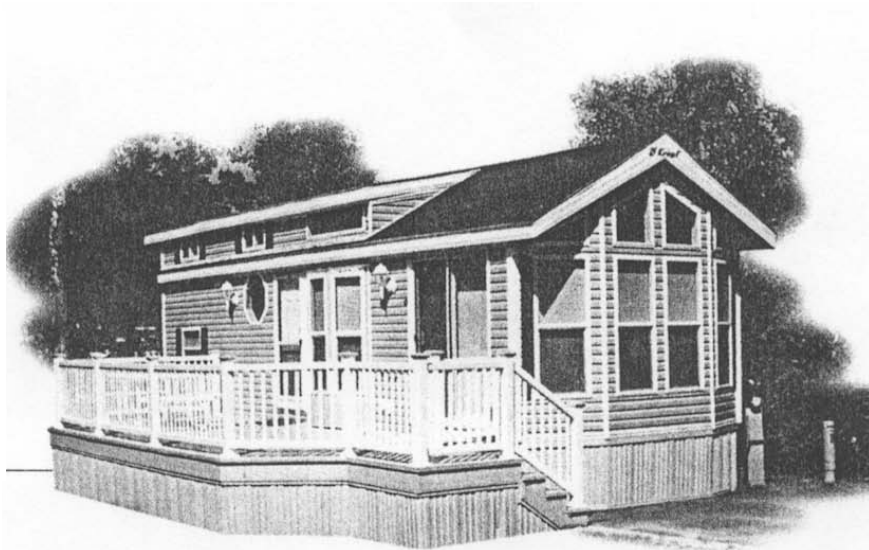

*We hope you had a wonderful Christmas
season! May you have a great New Years!*

See the variety and selection we have on display!

- *Canterbury* • *Dutch Park* • *Heritage* •
- *Kropf* • *Quailridge* • *Trophy* • *Woodland Park*